

Description

LH PACKAGING company specialized in vacuum packaging machine. The LH table top vacuum packaging machines series were designed with the user in mind. It's the ideal solution for the quick and easy packaging of smaller products. The gas flushing processes are pressure-controlled and thus guarantee a reproducible packing quality. The table top machines are easy to operate, clean and maintain. It's affordable enough to be purchased simply as a backup while maintaining superior quality that one can rely on during years of heavy use.

LH Table Top Vacuum Packaging Machines Series constructed of a high-quality

Technical Characters

1. Control System: The PLC control panel provides several control modes for user's selection.
2. Material of Main Structure: 304 stainless steel.
3. Hinges on Lid: The special labor-saving hinges on the lid markedly reduce the labor intensity of operator in daily work, so that they handle it with ease.
4. "V" Lid Gasket: The "V" shaped vacuum chamber lid gasket made of high-density material guarantees the sealing performance of the machine in routine work. The compression and wearing resistance of the material extends the service life of the lid gasket and reduce its changing frequency.
5. Electrical requirement and plug could be custom according to customer requirement.
6. Gas flushing is optional.
7. Insert plate is optional.

Machine Dimensions Drawing

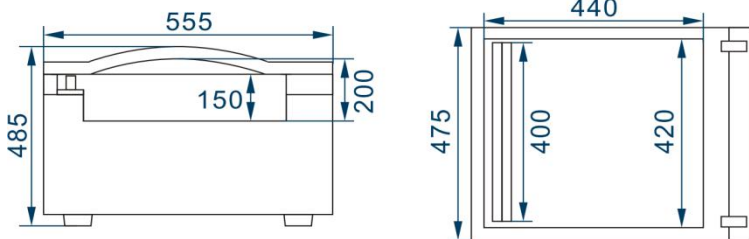

LH-400/G

TABLE TOP VACUUM PACKAGING MACHINE

Technical Specifications					
Model	LH-400/G	Vacuum Pump (m ³ /h)	20	Production Cycle (times/min)	2
Machine Dimensions (mm)	555×475×485	Power (kw)	0.75	Gross Weight (kg)	71
Chamber Dimensions (mm)	440×420×200(150)	Voltage (v)	1P/220	Net Weight (kg)	60
Sealer Dimensions (mm)	400×8	Frequency (Hz)	50	Shipping Dimensions (mm)	610×530×540

Data in parentheses indicates height of vacuum chamber